

11

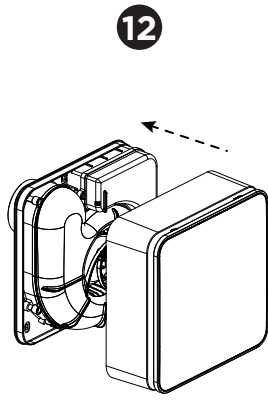

12

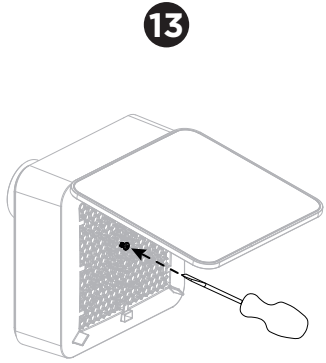

13

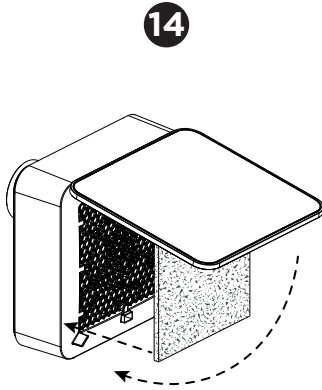

14

P06534001

GO.ERRE

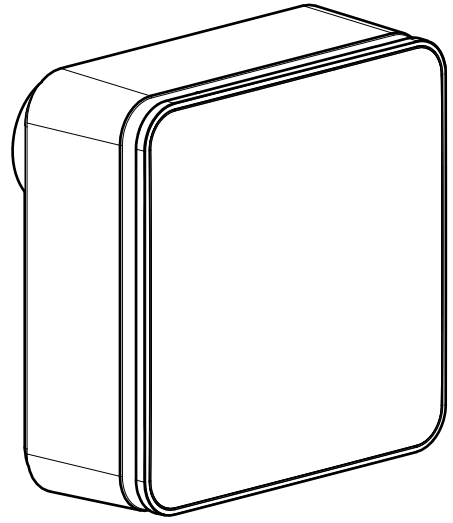

FLAT-e

EP S.p.A.

Via Del Commercio 1, 25039 - Travagliato (BS) Italy
tel. +39 030 68 62 341 - fax +39 030 68 62 051 | www.oerre.it - vendite@oerre.it

IT Prima di procedere con l'installazione leggere attentamente il manuale delle avvertenze generali. Read the precautions manual carefully before installing this appliance.

FR Avant de procéder à l'installation, il faut lire attentivement le manuel des instructions générales.

DE Bitte lesen Sie sich die Sicherheitshinweise der Gebrauchsanleitung aufmerksam durch, bevor Sie das Gerät installieren.

NL Lees de handleiding met voorzorgsmaatregelen zorgvuldig vooraf u dit apparaat installeert.

DA Læs venligst vejledningen grundigt, inden installation af dette produkt.

ES Lea detenidamente el manual de advertencias antes de instalar este aparato.

EL Διαβάστε τις οδηγίες προποσας προσεκτικά πριν εγκαταστήσετε τη συσκευή.

RU Перед установкой данного оборудования внимательно изучите инструкцию по технике безопасности.

SR Pre instaliranja ovog uređaja pažljivo pročitate priručnik o predostrožnosti.

HR Pažljivo pročitati mjere opreza prije ugradnje uređaja.

PL Przed zainstalowaniem tego urządzenia przeczytaj uważnie instrukcję dotyczącą środków ostrożności.

UK Перед тим, як встановлювати цей прилад, уважно прочитайте інструкції з техніки безпеки.

AR اقرأ دليل الأخطار بعناية قبل تثبيت هذا الجهاز.

MANUALE FLAT-e

IT ASPIRATORI CENTRIFUGHI
DA CONDOTTO
EN CENTRIFUGAL DUCT FAN
FR AÉRATEUR DE CONDUIT CENTRIFUGE
DE RADIALER SCHACHTVENTILATOR
NL CENTRIFUGAAL KANAAL VENTILATOR
DA CENTRIFUGAL VENTILATOR FOR KANAL
ES VENTILADOR CENTRÍFUGO
DE CONDUCTO
EL ΦΥΛΟΚΕΝΤΡΙΚΟΣ ΕΞΑΕΡΙΟΤΗΡΑΣ ΑΥΛΩΝ
RU ЦЕНТРОБЕЖНЫЙ КАНАЛЬНЫЙ ВЕНТИЛЯТОР
SR CENTRIFUGALNI KANALSKI
HR CENTRIFUGALNI, KANALSKI VENTILATOR
PL WENTYLATORY KANAŁOWE
ODŚRODKOWE
UK ВІДЦЕНТРОВИЙ ВЕНТИЛЯТОР
AR روجحة مركزية

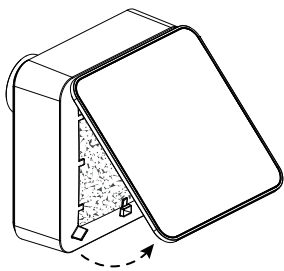
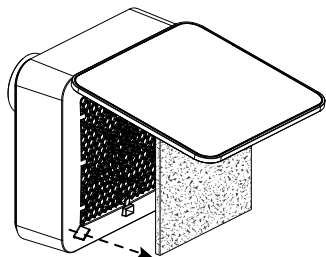
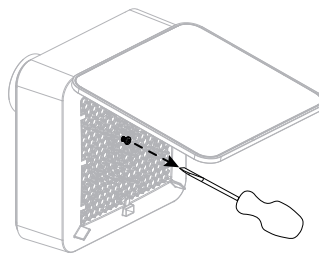
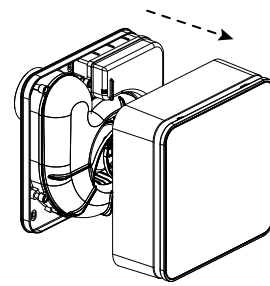
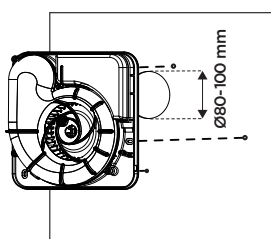
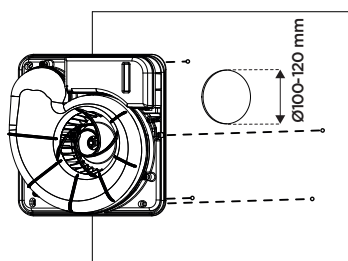
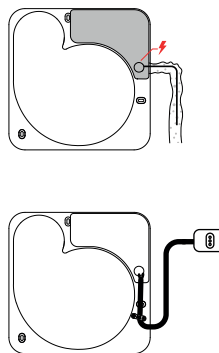
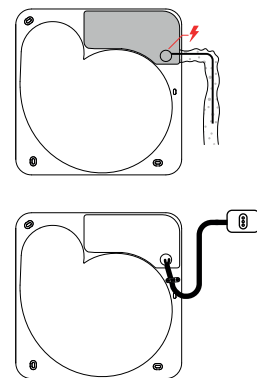
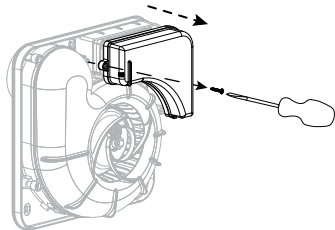
1**2****3****4****5a****FLAT-e 100****5b****FLAT-e 300****6a****FLAT-e 100****6b****FLAT-e 300****7****FLAT-e 100**

80 m³/h 100 m³/h

FLAT-e 300

175 m³/h 230 m³/h

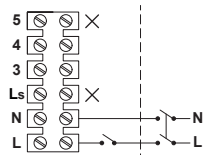
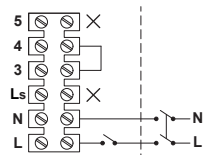
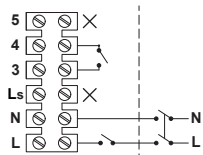
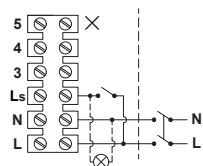
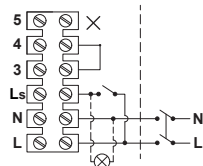
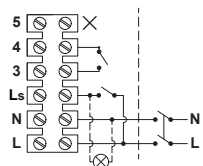
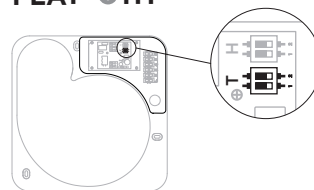
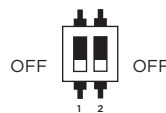
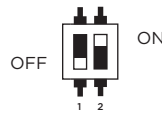
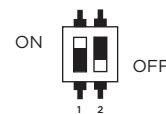
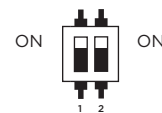
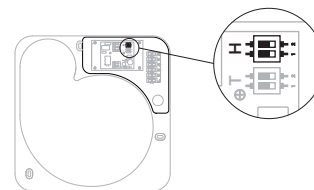
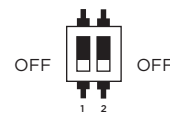
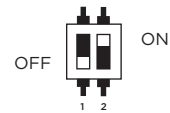
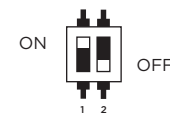
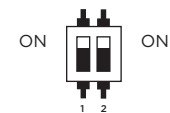
8**ELECTRICAL CONNECTION****FLAT-e****FLAT-eT / FLAT-eHT****9****TIMER****FLAT-eT
FLAT-eHT****3'****7'****15'****25'****10****HUMIDITY****FLAT-eHT****40%*****60%*****75%*****90%***

* The declared thresholds are based on test carried out in a climate chamber at a constant temperature of 20°C. The intervention threshold of the humidity sensor can differ from product to product and depends on environmental and atmospheric factors.